

**ITEM 50. TRAFFIC TREATMENT – BICYCLE LANE AND NO STOPPING –
REDFERN STREET REDFERN**

TRIM RECORD NO: 2017/209462

RECOMMENDATION

It is recommended that the Committee endorse the following changes on the southern side of Redfern Street, Redfern:

- (A) Reallocation of parking between the points 17 metres and 23 metres east of Elizabeth Street as “No Stopping”; and
- (B) Installation of an on-road bicycle lane between the points 10 metres and 23 metres east of Elizabeth Street.

It is recommended that the Committee note the installation of:

- (C) a bicycle storage area on the Redfern Street (East) approach of the signalised intersection with Elizabeth Street; and
- (D) bicycle lanterns at the Redfern Street (East) and Redfern Street (West) approaches of the signalised intersection with Elizabeth Street.

VOTING MEMBERS FOR THIS ITEM

<i>Voting Members</i>	<i>Support</i>	<i>Object</i>
City of Sydney		
Roads and Maritime Services		
NSW Police – Redfern LAC		
Representative for the Member for Newtown		

DECISION

BACKGROUND

Redfern Street forms part of the Bondi Junction to Newtown Regional Cycle Route and provides direct connectivity with major north-south cycle links like the Bourke and George Street separated cycleways.

To improve cyclist priority along this key regional route, the City proposes the following improvements at the signalised intersection of Redfern and Elizabeth Streets:

- Installation of an on-road bicycle lane on approach to the Redfern Street (East) leg;
- Installation of a bicycle storage area on the Redfern Street (East) approach; and
- Addition of bicycle lanterns at the Redfern Street (East) and Redfern Street (West) approaches of the signalised intersection.

Installation of the on-road bicycle lane on approach to the Redfern Street (East) leg will result in the loss of one unrestricted on-street parking space.

COMMENTS

On 2 May 2017, Roads and Maritime Services (RMS) approved the new Traffic Control Signal (TCS) Plan for the signalised intersection of Redfern and Elizabeth Streets. The updated TCS Plan included the proposed bicycle storage area, as well as the bicycle lanterns at the Redfern Street (East) and Redfern Street (West) approaches.

In compliance with the RMS Technical Direction for Bicycle Storage Areas (TDT 2009/06), the City must provide a dedicated on-road bicycle lane on approach to the proposed bicycle storage area. Installation of the on-road bicycle lane will require the removal of one unrestricted on-street parking space and installation of a “No Stopping” restriction.

CONSULTATION

The City consulted local residents and businesses in the area. There were 92 letters sent out with no responses supporting the proposal and one response opposing the proposal.

The submission opposing the proposal was concerned about the loss of the on-street parking space.

Given the proposal will considerably increase safety and accessibility for cyclists on approach to the signalised intersection, the positive benefits of the proposal significantly outweigh the loss of one on-street parking space.

FINANCIAL

Funds are available in the current budget as part of the City's Cycling Safety Program.

ATTACHMENTS

Traffic Treatment – Bicycle Lane and No Stopping – Redfern Street Redfern

Justin Murphy, Senior Designer – Cycling

Redfern Street and Elizabeth Street, Redfern

Safety improvements for bike riders

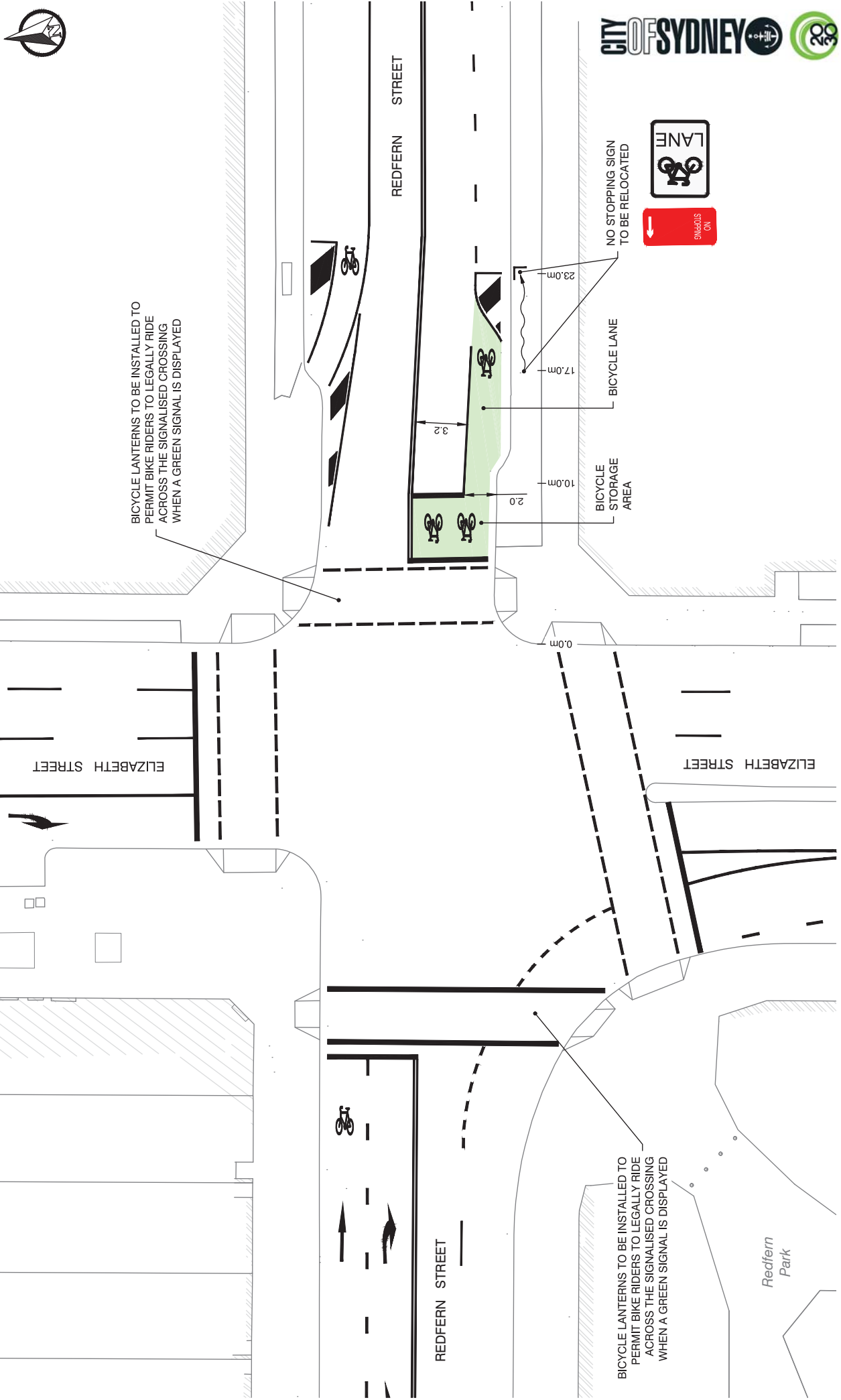

BICYCLE LANTERNS TO BE INSTALLED TO PERMIT BIKE RIDERS TO LEGALLY RIDE ACROSS THE SIGNALISED CROSSING WHEN A GREEN SIGNAL IS DISPLAYED

BICYCLE LANTERNS TO BE INSTALLED TO PERMIT BIKE RIDERS TO LEGALLY RIDE ACROSS THE SIGNALISED CROSSING WHEN A GREEN SIGNAL IS DISPLAYED

**DRAWN BY CADD
DO NOT AMEND MANUALLY**

TCS 0400

NOTES

1. This site is SCATS linked.
2. Audio-tactile push buttons are located on Posts 1, 2, 4, 5, 6, 7, 8 and 9.
3. Special Stop Sign (R1-4) placed on Post 1 and 6.
4. Council to trim and maintain trees on all approaches to ensure visibility of the lantern displays.
5. Bicycle detectors in accordance with drawings VC005-36, 37 and 38.
6. The approach bicycle lane and storage area to have green pavement colouring in accordance with City of Sydney guidelines, and NSW Bicycle guidelines.
7. For details of civil construction works refer to Drawing E3-16/1489 prepared by City of Sydney Council.

SIGNAL GROUP PHASE CHART

SIGNAL GROUP	PHASE	GREEN TIME	TABLE TYPE	REMARKS
V1	X	X	3	
V2	X	X	3	
V3	C			Timed Red Arrow protection for P2 WALK and CLEARANCE. Flashing Yellow for rest of CLEARANCE. Minimum Green after CLEARANCE.
V4	C			Timed Red Arrow protection for P3 pedestrians
V5	X	X	3	
V6	X	42		Full Red Arrow protection for P3 pedestrians Z-Filter Option
V7	X	30		Timed Red Arrow protection for P1 pedestrians
P1	X	X	6	Auto introduction in presence of XSF 1
P2	X	X	1	
P3	X	X	1	
P4	X	X	6	Auto introduction in presence of XSF 2

DETECTOR SCHEDULE

Detector	Specifications
A-B	FN ALU (AEZ) B DS B (BNEXT) ANEXT FN ALU (AE1) D(1) D DS V2 D (DNEXT) ANEXT
A-D	FN DLU (DE1) B DS B (BNEXT) ANEXT
B	FN DLU (DE1) B DS B (BNEXT) ANEXT
C1	FN DLU (DE1) B DS B (BNEXT) ANEXT
C2	FN DLU (DE1) B DS B (BNEXT) ANEXT
C-D1	FN DLU (DE1) B DS B (BNEXT) ANEXT
C-D1	FN DLU (DE1) B DS B (BNEXT) ANEXT
C-D2	FN DLU (DE1) B DS B (BNEXT) ANEXT
P1	FN ALU (AEZ) B DS B (BNEXT) ANEXT
P2	FN ALU (AEZ) B DS B (BNEXT) ANEXT
P3	FN ALU (AEZ) B DS B (BNEXT) ANEXT
P4	FN ALU (AEZ) B DS B (BNEXT) ANEXT

POST	TYPE	LENGTH	OFFSET	REMARKS
1	2	4.1	1.9	EXISTING
2	ELP	-	0.6	EXISTING
3	2	4.1	0.6	EXISTING
4	15	9.6	0.6	EXISTING (MA 2.5m outreach) 756kg
5	14	9.6	0.7	EXISTING 247kg
6	14	9.6	0.7	EXISTING 380kg
7	14	9.6	0.7	EXISTING 380kg
8	2	4.1	0.6	EXISTING
9	2	4.1	1.3	EXISTING

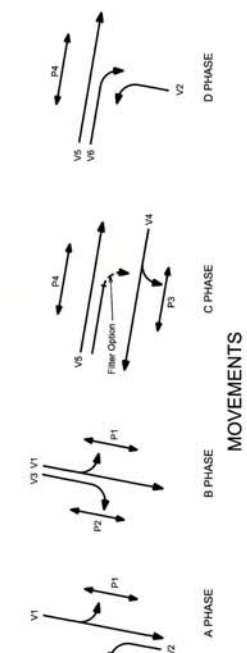
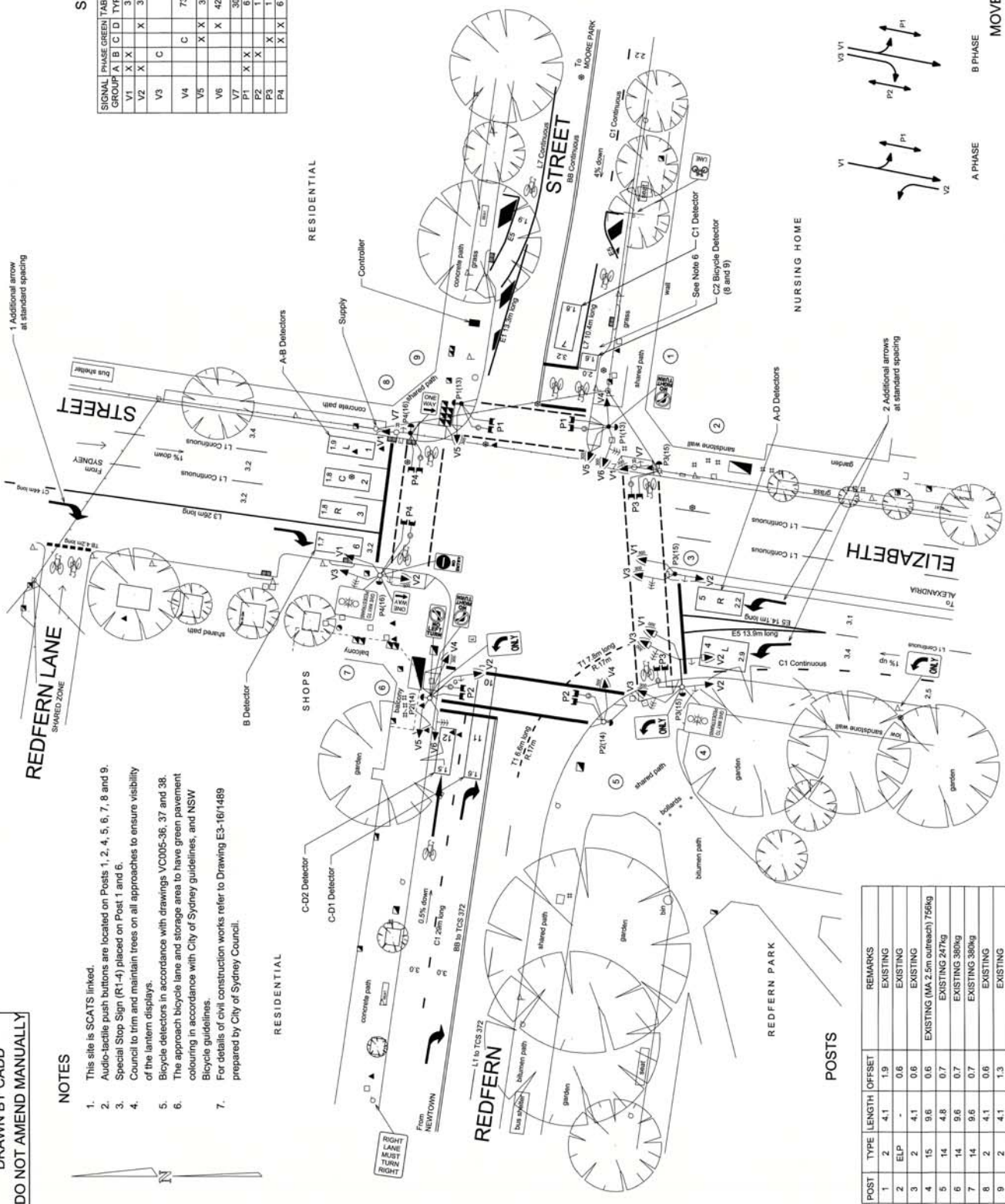

ROADS AND MARITIME SERVICES

SYDNEY COUNCIL AREA
 TRAFFIC SIGNALS AT
 ELIZABETH STREET AND REDFERN STREET,
 REDFERN

DESIGN LAYOUT TCS No. 0400

EXISTING PROPOSED

CADD FILE: VV0400_15A.dgn

SCALE: 1:1000

FILE: SF2014/0007645

REG No. DS2014/000772

TCS No. 0400

SHEET 15

DESIGN APPROVAL

APPROVED: [Signature]
 ROAD DESIGNER: [Signature]
 DATE: 13/01/17

RECOMMENDED

POSITION: [Signature]
 DATE: 13/01/17

ACCUSED

POSITION: [Signature]
 DATE: 13/01/17

REFERENCE PLANS

U.S.D. No. 15/140
 U.S.D. No. 15/140
 U.S.D. No. 15/140

PUBLIC UTILITY LEGEND

STOP VALVE
 GAS VALVE
 WATER METER
 TELEPHONE POLE
 POWER POLE
 STAY POLE
 TELEPHONE BOX
 TELECOM PIPES